

Pump type: Submersible cutter pump
 Application: Waste water, sewage

Pump data

Discharge diameter 30 mm
 Impeller type: with cutter
 Impeller diameter 120 mm
 Recommended min. flow 0.5 l/sec (2 m3/h)
 Weight 34 kg

Motor

Mains: 50 Hz – 3 phase
 Rated shaft power 1.5 kW
 Rated electrical power 2.1 kW
 Nominal speed 2790 rpm
 Motor efficiency 71 %
 Power factor (cos phi) 0.91
 Degree of protection IP 68
 Isolation class F (155°C)
 Max. water temperature 40°C
 Standard cable length 10 m

Materials

Pump casing Cast iron GG 25 (EN-GJL-250)
 Impeller Cast iron GG 25 (EN-GJL-250)
 Cutter Hardened chrome steel
 Motor unit Cast iron GG 25 (EN-GJL-250)
 Shaft AISI 431
 Alt: AISI 316
 Bolts AISI 316
 Elastomers Nitrile (NBR) or neoprene (CR)
 Alt: Viton (FPM)
 Electrical cable Neoprene (CR)
 Seal lubrication Oil
 Seal pump side Silicon carbide – Silicon carbide
 Seal motor side Carbon - Ceramic
 Coating Two components Polyurethane

Installation options

Header coupling BWK050, 065 or 080

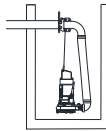

Guide bar coupling OWK050

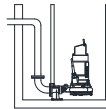

Optional

- Thermo switches in stator windings
- Cable protective sheathing (AISI 316)
- Water detector in motor and oil chamber

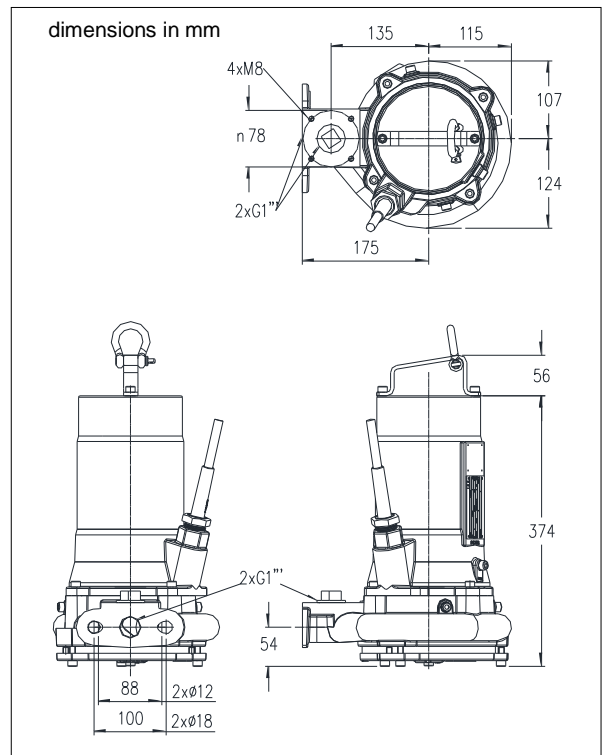
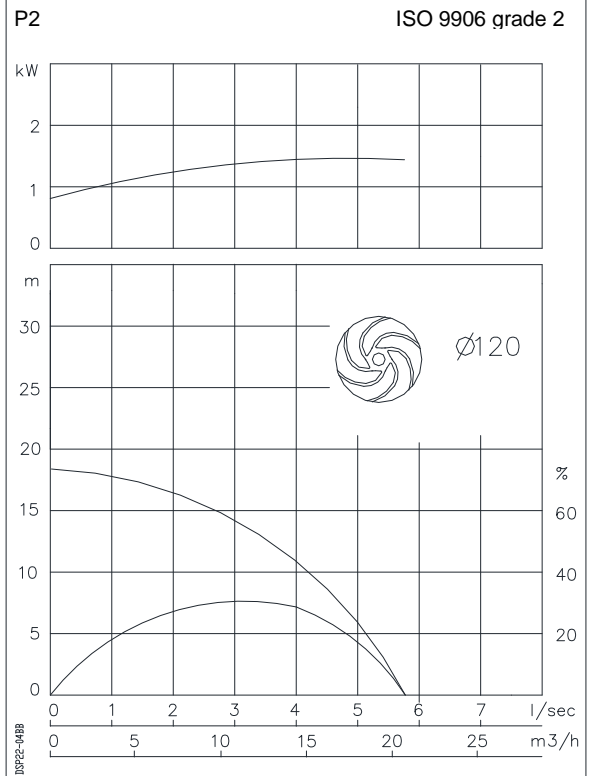

Connections

voltage	current	Electrical cable size [mm ²]		motor protection and/or water detector	
		direct start		direct start	
230	5.8	4G1.5		7G1.5	
400	3.3	4G1.5		7G1.5	
500	2.7	4G1.5		7G1.5	
starting current DOL start : 4.8 x rated current					
* other voltages on request					