

Pump type: Submersible cutter pump  
 Application: Waste water, sewage

**Pump data**

Discharge diameter: 30 mm  
 Impeller type: with cutter  
 Impeller diameter: 150 mm  
 Recommended min. flow: 0.5 l/sec (2 m3/h)  
 Weight: 36 kg

**Motor**

Mains: 50 Hz – 3 phase  
 Rated shaft power: 2.6 kW  
 Rated electrical power: 3.5 kW  
 Nominal speed: 2800 rpm  
 Motor efficiency: 74 %  
 Power factor (cos phi): 0.91  
 Degree of protection: IP 68  
 Isolation class: F (155°C)  
 Max. water temperature: 40°C  
 Standard cable length: 10 m

**Materials**

Pump casing: Cast iron GG 25 (EN-GJL-250)  
 Impeller: Cast iron GG 25 (EN-GJL-250)  
 Cutter: Hardened chrome steel  
 Motor unit: Cast iron GG 25 (EN-GJL-250)  
 Shaft: AISI 431  
 Bolts: Alt: AISI 316  
 Elastomers: Nitrile (NBR) or Neoprene (CR)  
 Alt: Viton (FPM)  
 Electrical cable: Neoprene (CR)  
 Seal lubrication: Oil  
 Seal pump side: Silicon carbide – Silicon carbide  
 Seal motor side: Carbon - Ceramic  
 Coating: Two components Polyurethane

**Installation options**

Header coupling: BWK050, 065 or 080

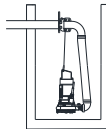

Guide bar coupling: OWK050

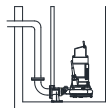

**Optional**

- Thermo switches in stator windings
- Cable protective sheathing (AISI 316)
- Water detector in motor and oil chamber

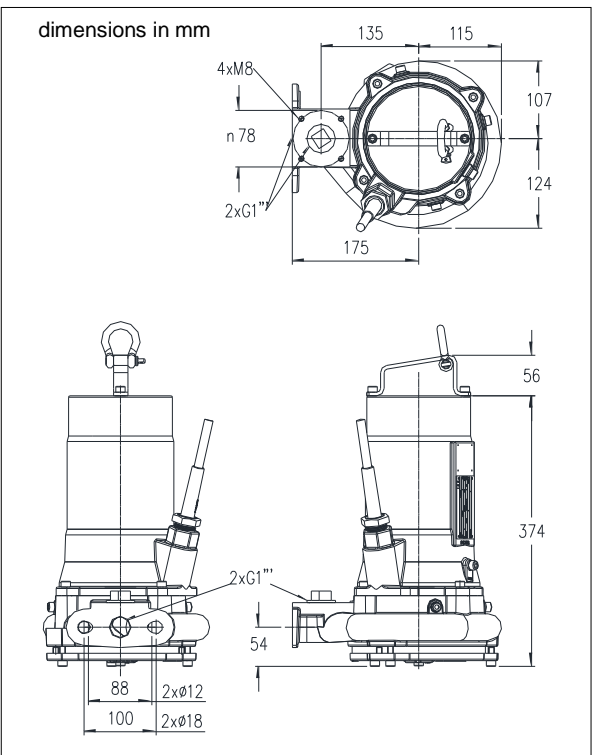
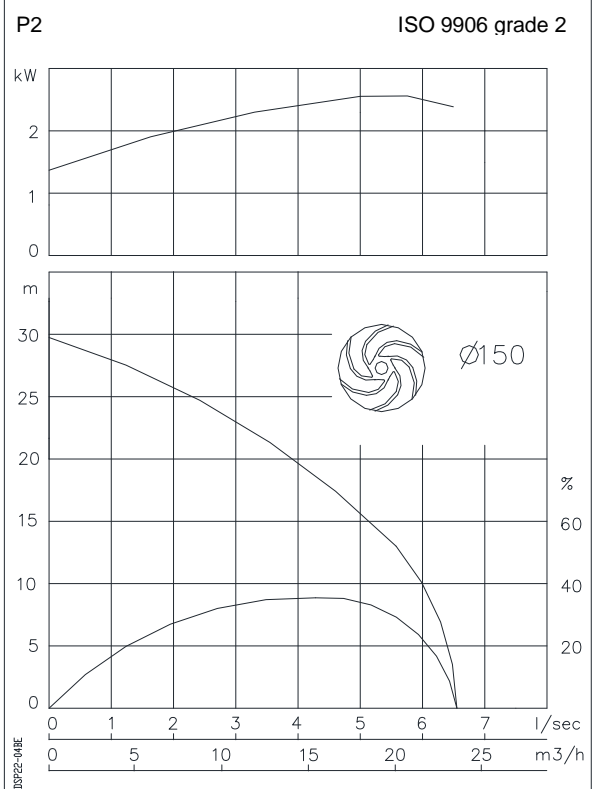

**Connections**

voltage	current	Electrical cable size [mm2]		motor protection and/or water detector	
		direct start		direct start	
230	9.7	4G1.5		7G1.5	
400	5.6	4G1.5		7G1.5	
500	4.5	4G1.5		7G1.5	
starting current DOL start : 4.6 x rated current					
* other voltages on request					